

CLASS 150/300/600

- OS & Y Risign Stem, Flexible Wedge, Full Guided
- Renewable Seat Rings, Bolted Bonnet
- Connection: Flanged end, Butt Weld End.
-
- Aplicable Standards:
- Face-To-Face: ANSI B16.10
- End Flanged : ANSI B16.5
- Basic Design: ANSI B16.34, API 600
- Butt Weld Ends: ANSI B16.5
- Inspection And Test: API 598
- Working temperature: -29° C – 425° C
- Available With gear Operator

• DIMENSIONS LIST

| Code | CH | CHY | CY | CP8 | CP8Y | CR8 | CR8Y | CM | P8 | P8WY | P8Y |
|-------------|---------------|------|-----|----------------|------|------|----------------|-------|---------------|------|-----|
| Shell | ASTM A216-WCB | | | | | | | | ASTM A351-CF8 | | |
| Disc | WCB | | | CF8 | | CF8M | | Monel | ASTM A351-CF8 | | |
| Stem | F6a | | | F304 | | F316 | | Monel | F304 | | |
| Disc facing | 13CR | 13CR | STL | 304 | STL | 316 | STL | Monel | 304 | 304 | STL |
| Seat facing | 13CR | STL | STL | 304 | STL | 316 | STL | Monel | 304 | 304 | STL |
| | | | | | | | | | | | |
| Code | P3 | P3WY | P3Y | R8 | R8WY | R8Y | R3 | R3WY | R3Y | | |
| Shell | ASTM A351-CF3 | | | ASTM A351-CF8M | | | ASTM A351-CF3M | | | | |
| Disc | ASTM A351-CF3 | | | ASTM A351-CF8M | | | ASTM A351-CF3M | | | | |
| Stem | F304L | | | F316 | | | F316L | | | | |
| Disc facing | 304L | 304L | STL | 316 | 316 | STL | 316L | 316L | STL | | |



Figure Number Examples: Z40AA-CH stands for gate valve with RF end connections, single and flexible disc, class 150, ASTM A-216 WCB Shell & disc and ASTM A182-F6a stem, 13Cr disc facing and seat facing. Z4-0AB-P8Y-B stands for gate valve with RTJ end connections, single and flexible disc, ASTM A351-CF8 shell & disc, ASTM A182-F304 stem, stellite (STL) disc facing and seat facing, bevel gear operation.

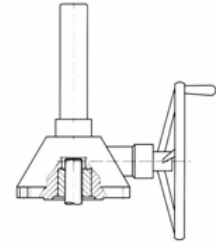
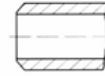
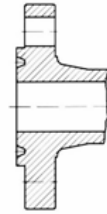
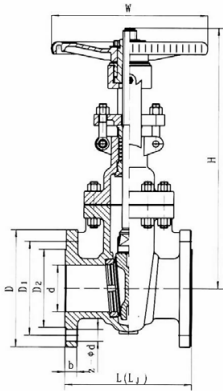

Ring Type Joint End, Butt-welding End, Worm Gear Operator

in inches

| class | Size | d | L | LJ | D | D1 | D2 | b | Z d | w | H(open) | Wt(kg) |
|-------|-------|-------|--------|--------|--------|--------|--------|----------|----------|--------|---------|--------|
| 150 | 2 | 2 | 7 | - | 6 | 4 3/4 | 3 5/8 | 5/8 | 4-3/4 | 7 7/8 | 15 3/4 | 19 |
| | 2 1/2 | 2 1/2 | 7 1/2 | - | 7 | 5 1/2 | 4 1/8 | 11/16 | 4-3/4 | 7 7/8 | 17 3/4 | 29 |
| | 3 | 3 | 8 | - | 7 1/2 | 6 | 5 | 3/4 | 4-3/4 | 10 | 20 1/4 | 33 |
| | 4 | 4 | 9 | - | 9 | 7 1/2 | 6 3/16 | 15/16 | 8-3/4 | 11 | 23 1/2 | 47 |
| | 6 | 6 | 10 1/2 | - | 11 | 9 1/2 | 8 1/2 | 1 | 8-7/8 | 11 3/4 | 30 1/2 | 76 |
| | 8 | 8 | 11 1/2 | - | 13 1/2 | 11 3/4 | 10 5/8 | 1 1/8 | 8-7/8 | 13 3/4 | 38 1/4 | 120 |
| | 10 | 10 | 13 | - | 16 | 14 1/4 | 12 3/4 | 1 3/16 | 12-1 | 15 3/4 | 46 1/4 | 190 |
| | 12 | 12 | 14 | - | 19 | 17 | 15 | 1 1/4 | 12-1 | 17 3/4 | 54 1/2 | 290 |
| | 14 | 14 | 15 | - | 21 | 18 3/4 | 16 1/4 | 1 3/8 | 12-1 1/8 | 19 3/4 | 61 1/2 | 365 |
| | 16 | 16 | 16 | - | 23 1/2 | 21 1/4 | 18 1/2 | 1 7/16 | 16-1 1/8 | 23 1/2 | 68 1/2 | 456 |
| | 18 | 18 | 17 | - | 25 | 22 3/4 | 21 | 1 9/16 | 16 1 1/8 | 26 1/2 | 76 3/4 | 712 |
| | 20 | 20 | 18 | - | 27 1/2 | 25 | 23 | 1 11/16 | 20-1 1/4 | 29 1/2 | 85 1/2 | 860 |
| 24 | 24 | 20 | - | 32 | 29 1/2 | 27 1/4 | 1 7/8 | 20-1 3/8 | 29 1/2 | 101 | 1175 | |
| 300 | 2 | 2 | 8 1/2 | 9 1/8 | 6 1/2 | 5 | 3 5/8 | 7/8 | 8-3/4 | 7 7/8 | 16 1/2 | 29 |
| | 2 1/2 | 2 1/2 | 9 1/2 | 10 1/8 | 7 1/2 | 5 7/8 | 4 1/8 | 1 | 8-7/8 | 7 7/8 | 18 1/2 | 37 |
| | 3 | 3 | 11 1/8 | 11 3/4 | 8 1/4 | 6 5/8 | 5 | 1 1/8 | 8-7/8 | 10 | 21 1/8 | 49 |
| | 4 | 4 | 12 | 12 5/8 | 10 | 7 7/8 | 6 3/16 | 1 1/4 | 8-7/8 | 11 | 24 3/8 | 69 |
| | 6 | 6 | 15 7/8 | 16 1/2 | 12 1/2 | 10 5/8 | 8 1/2 | 1 7/16 | 12-7/8 | 13 3/4 | 31 3/4 | 137 |
| | 8 | 8 | 16 1/2 | 17 1/8 | 15 | 13 | 10 5/8 | 1 5/8 | 12-1 | 15 3/4 | 39 1/8 | 235 |
| | 10 | 10 | 18 | 18 5/8 | 17 1/2 | 15 1/4 | 12 3/4 | 1 7/8 | 16-1 1/8 | 17 3/4 | 47 3/8 | 315 |
| | 12 | 12 | 19 3/4 | 20 3/8 | 20 1/2 | 17 3/4 | 15 | 2 | 16-1 1/4 | 19 3/4 | 55 3/4 | 460 |
| 600 | 2 | 2 | 11 1/2 | 11 5/8 | 6 1/2 | 5 | 3 5/8 | 1 | 8-3/4 | 8 | 17 | 40 |
| | 2 1/2 | 2 1/2 | 13 | 13 1/8 | 7 1/2 | 5 7/8 | 4 1/8 | 1 1/8 | 8-7/8 | 10 | 19 1/8 | 50 |
| | 3 | 3 | 14 | 14 1/8 | 8 1/4 | 6 5/8 | 5 | 1 1/4 | 8-7/8 | 12 | 21 1/2 | 70 |
| | 4 | 4 | 17 | 17 1/8 | 10 3/4 | 8 1/2 | 6 3/16 | 1 1/2 | 8-1 | 14 | 25 1/2 | 120 |
| | 6 | 6 | 22 | 22 1/8 | 14 | 11 1/2 | 8 1/2 | 1 7/8 | 12-1/8 | 18 | 31 1/2 | 265 |
| | 8 | 8 | 26 | 26 1/8 | 16 1/2 | 13 3/4 | 10 5/8 | 2 3/16 | 12-1 1/4 | 22 | 40 1/2 | 400 |
| | 10 | 10 | 31 | 31 1/8 | 20 | 17 | 12 3/4 | 2 1/2 | 16-13/8 | 24 | 50 | 700 |
| | 12 | 12 | 33 | 33 1/8 | 22 | 19 1/4 | 15 | 2 5/8 | 20-1 3/8 | 28 | 58 1/2 | 955 |

We hereby reserve the rights of any alternative dimension that would help to improve our valve's quality and working efficiency