



**MODEL NO: 300BR**

FORGED STEEL CLASS 800 CHECK VALVE  
 LIFT TYPE,  
 BOLTED CAP, OPTIONAL: WELD CAP.  
 MANUFACTURE AND DESIGN:  
 API 602/ ANSI B16.34,  
 FULL PORT/ STANDARD PORT  
 CONNECTRION: THREADED ENDS, SOCKET ENDS  
 THREAD TYPE(NPT, BSPT, DIN ENDS)  
 INSPECTION AND TEST: API 598  
 PRESSURE RATING: SHELL: 3000PSI  
 SEAT: 2200PSI

AIR TEST: 80~100PSI

MATERIAL: A105, A182 F304/ F316/ F11/ F22/ F304L/ F316L

SIZE: 1/4"~2"

**PARTS AND MATERIAL:**

NO.	PARTS NAME	MATERIALS		
1	BODY	ASTM A105	A182 F304	A182 F316
2	DISC	F6	A182 F304	A182 F316
4	GASKET	GRAPHITE+304		GRAPHITE+316
5	CAP	ASTM A105	A182 F304	A182 F316
6	CAP BLOT	ASTM A193 B7	ASTM A193 B8	

OTHER MATERIALS ARE AVAILABLE UPON REQUEST.

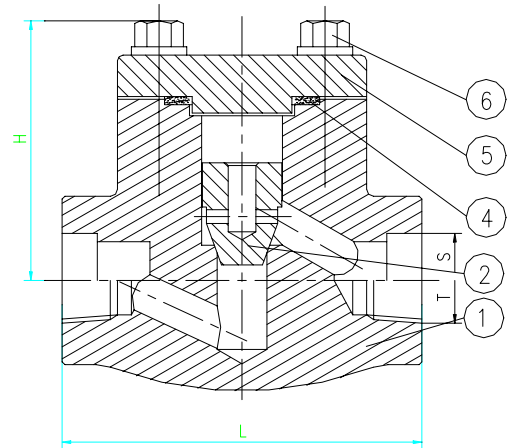

**DIMENSIONS LIST:**

UNIT: MM

DN		SIZE		T (THREAD)		S (SOCKET)		L	H	WT (KG)
REGULAR	FULL	REGULAR	FULL	REGULAR	FULL	REGULAR	FULL			
8		1/4"		1/4"		14.2		79	61	1.5
10	8	3/8"	1/4"	3/8"	1/4"	17.6	14.2	79	61	1.4
15	10	1/2"	3/8"	1/2"	3/8"	21.8	17.6	79	61	1.2
20	15	3/4"	1/2"	3/4"	1/2"	27.1	21.8	92	61	1.4
25	20	1"	3/4"	1"	3/4"	33.8	27.1	111	78	2.3
32	25	1-1/4"	1"	1-1/4"	1"	42.6	33.8	120	84	3.9
40	32	1-1/2"	1-1/4"	1-1/2"	1-1/4"	48.7	42.6	152	103	5.6
50	40	2"	1-1/2"	2"	1-1/2"	61.1	48.7	172	118	8.9
	50		2"		2"		61.1	200	132	12.5

We hereby reserve the rights of any alternative dimension that would help to improve our valve's quality and working efficiency